

# Tefal®

## VERSALIO DELUXE

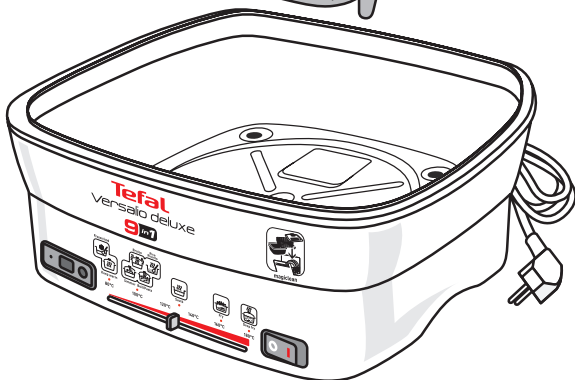

[www.tefal.com](http://www.tefal.com)

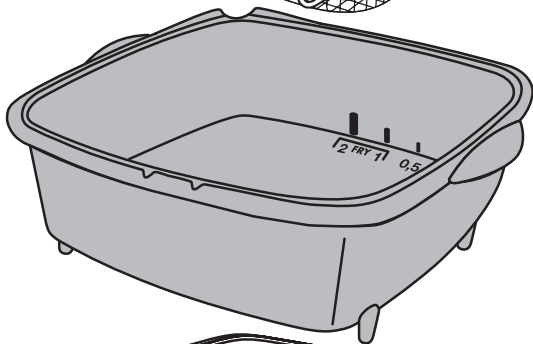
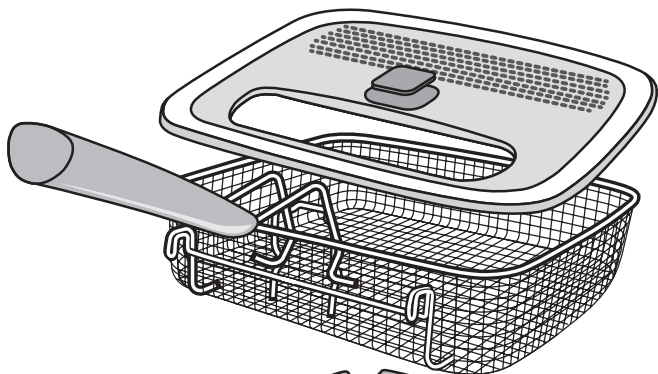

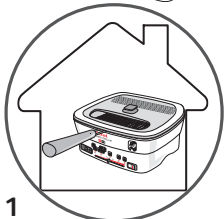

1

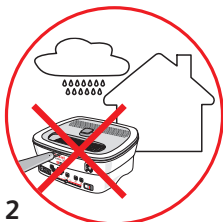

2



1

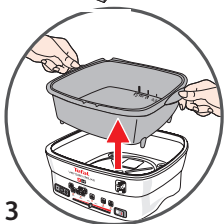

3

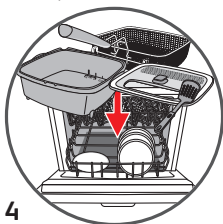

4



5

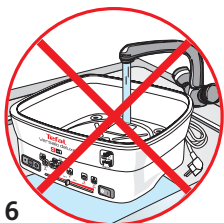

6



7



8

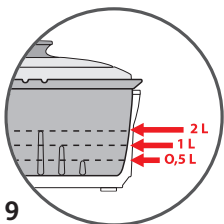

9



10

2



Fry



Deep fry

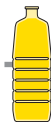

0,5 L

Fry



2 L

Deep fry



11

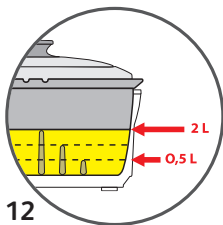

12

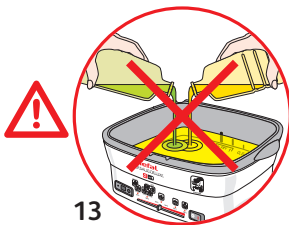

13



< 0,5 L

Fry



1 L → 2 L

Deep fry

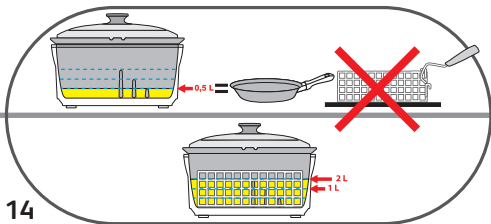

14

3



Deep fry



Max 1000 g

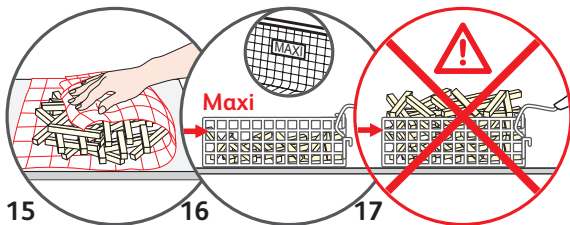

15

16

17



Max 750 g

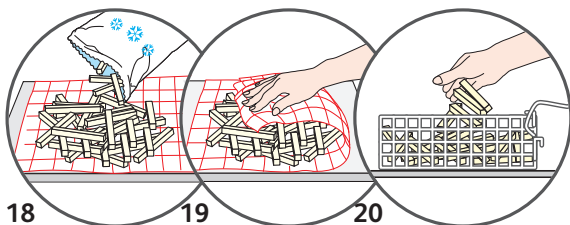

18

19

20



21

22

23



Deep fry

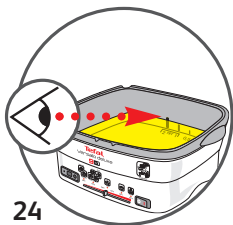

24



25

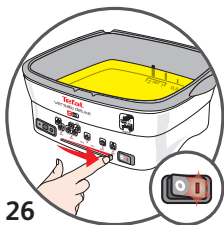

26

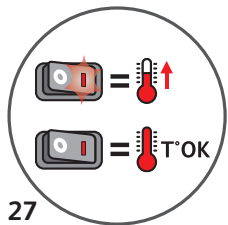

27

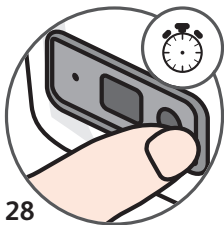

28

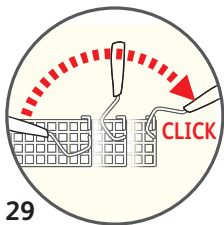

29

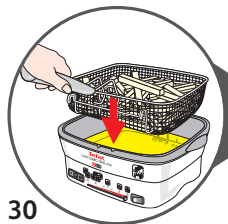

30

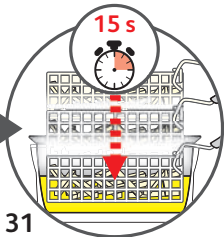

31

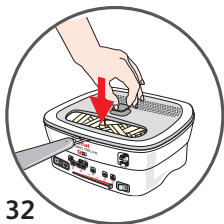

32



33



34

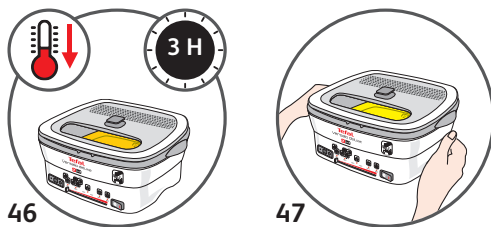
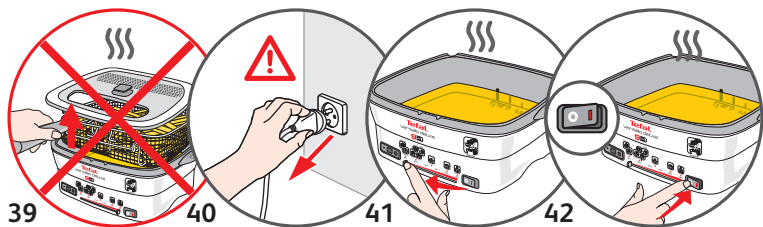
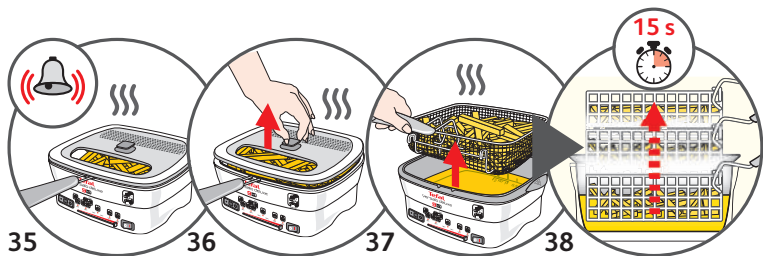







## 5 Deep fry / 180 °C



Deep fry







 2 L maxi			
	1000 g	15-16 min	4
	550 g	10-11 min	
	750 g	13-14 min	
	400 g	7-8 min	



## 6 Fry / 160 °C



Fry

 0,5 L maxi		
	15 min	4
	30 min	6





## 7 Sauté / 130 °C



Sauté

x1	10 min	4



## 8 Simmer / 100 °C



Simmer

30 min	4

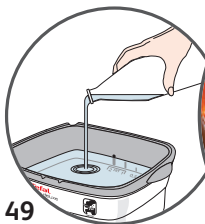

## 9 Boil/Pasta



Boil/Pasta

30 min	4

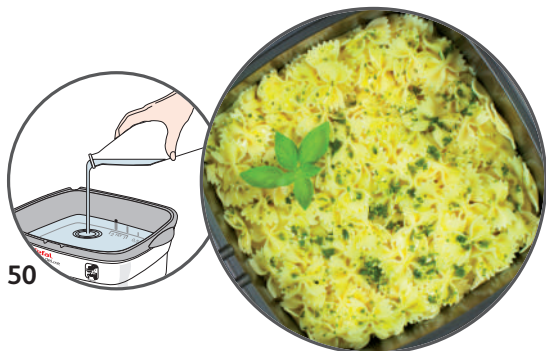

## 10 Rice/Risotto



Rice/Risotto

15 min	4

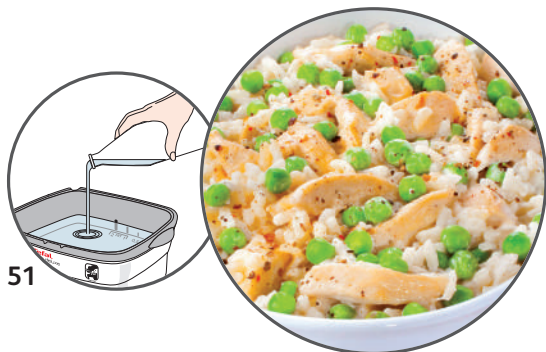

**11****Braise**

Braise

40  
min

4

52

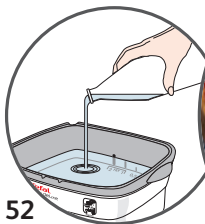

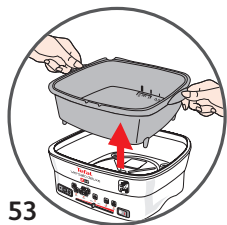
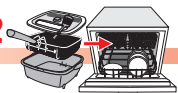

53

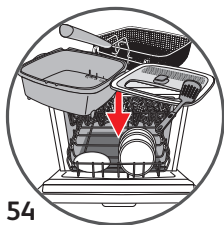

54

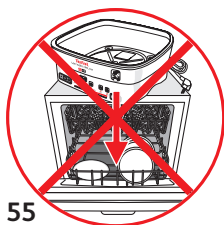

55

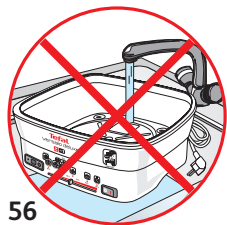

56

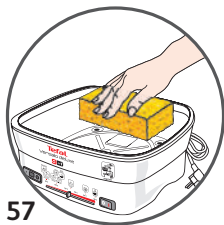

57



58

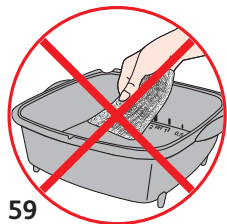

59

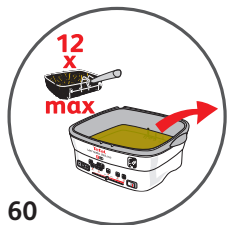

60

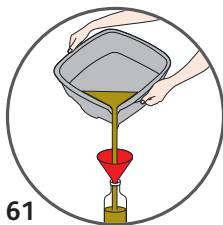

61



62



63



64

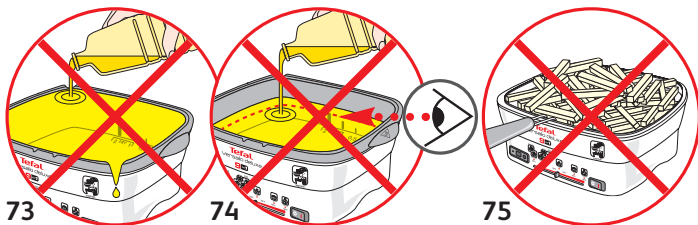
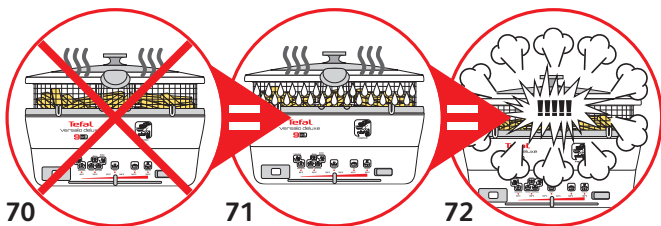
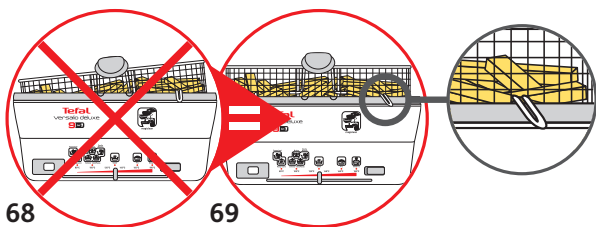
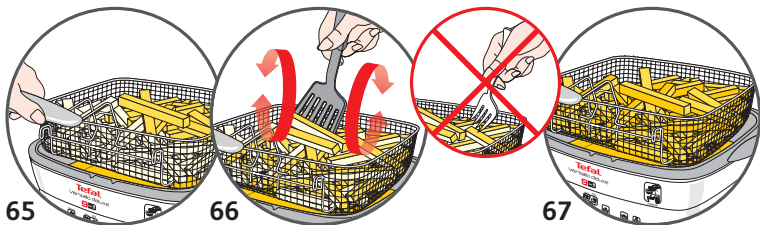



76



77

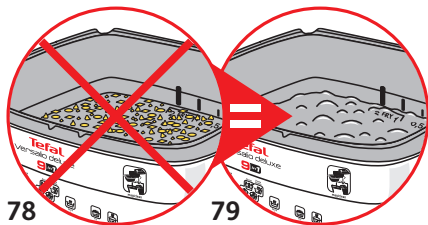

78

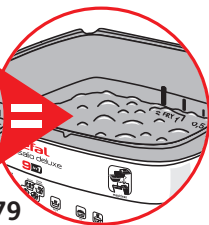

79

